

NOTICE!!

These documents have been scanned!

Do not place un-scanned documents beneath this notice!

Do not remove this notice from this file!

GPO Jacket No. 560-102
Print Order 61540
Rise Business Services, LLC
Job=AZ15 6/24/2019



Box Number= AZ15128



Claim Begin-End: AMC427582-AMC427582

1 Initial Receipt



AZ15128-10

AMC427444-AMC427733

United States Department of the Interior
Bureau of Land Management
 BUSINESS & SUPPORT SVCS DIV
 ONE N CENTRAL AVE SUITE 800
 PHOENIX, AZ 85004 -4427
 Phone: (602) 417-9200

Receipt

No: 3345205

Transaction #: 3442977	
Date of Transaction: 07/17/2015	
CUSTOMER:	
CRYSTAL SUTTON 2091 E MURRAY HOLLADAY RD #22E SLC,UT 84117 US	

LINE #	QTY	DESCRIPTION	REMARKS	UNIT PRICE	TOTAL
1	1.00	LOCATABLE MINERALS / MINING CLAIMS- NOT NEW-UNADJUD,ONE AUTH NO. ONLY / MINING CLAIM MONEY RECEIVED CASES: AMC427582/\$155.00		- n/a -	155.00
TOTAL:					\$155.00

PAYMENT INFORMATION			
NOTE: Items will appear on credit card statement as "BLM O Mining Claim".			
1	AMOUNT:	155.00	POSTMARKED: N/A
	TYPE:	CREDIT CARD	RECEIVED: 07/17/2015
	NAME:	CRYSTAL SUTTON 2091 E MURRAY HOLLADAY RD #22E SLC UT 84117 US	
	CARD NO:	XXXXXXXXXXXX4136	AUTH CODE: 016223
	NAME ON CARD:	CRYSTAL SUTTON	
	EXPIRES:	11/2015	
	SIGNATURE:		

REMARKS

This receipt was generated by the automated BLM Collections and Billing System and is a paper representation of a portion of the official electronic record contained therein.

Run Date: 07/23/15

Run Time: 01:44 PM

**DEPARTMENT OF THE INTERIOR
BUREAU OF LAND MANAGEMENT
MINING CLAIMS**

MC Maintenance Fees Paid Through the BLM Pay Portal

CBS Receipt: 3345205

Printed For Lead File # AMC427582

Agency Tracking ID: 1437146485

Assessment Year: 2016

Number of BLM Serial Nr: 1

Paid On: 07/17/2015

Total Amount Paid: \$155.00

Claim Name	BLM Serial No	Lead File No	Amount Paid
NELLIE MEDA	AMC427582	AMC427582	\$155.00

AMC#

DATE CLOSED

REMARKS

AMC#	DATE CLOSED	REMARKS
427582		

United States Department of the Interior
Bureau of Land Management
 LANDS/RECREATION & PLANNING
 ONE N CENTRAL AVE
 PHOENIX, AZ 85004 -2203
 Phone: 602-417-9200



Receipt

No: 2991178

Transaction #: 3080544	
Date of Transaction: 03/18/2014	
CUSTOMER:	
GRE INC 2091 MURRAY HOLLADAY RD STE 22 SALT LAKE CITY, UT 84117-5174 US	

LINE #	QTY	DESCRIPTION	REMARKS	UNIT PRICE	TOTAL
1	1.00	LOCATABLE MINERALS / MINING CLAIMS-NEW, UNADJUD, ONE OR MORE AUTH NOS / NEW MINING CLAIM LOCATION FEE \$34 CASES: AMC427582/\$34.00		- n/a -	34.00
2	1.00	LOCATABLE MINERALS / MINING CLAIMS-NEW, UNADJUD, ONE OR MORE AUTH NOS / NEW MINING CLAIM MAINT FEE \$140 CASES: AMC427582/\$140.00		- n/a -	140.00
3	1.00	LOCATABLE MINERALS / MINING CLAIMS-NEW, UNADJUD, ONE OR MORE AUTH NOS / NEW MINING CLAIM PROCESSING FEE CASES: AMC427582/\$20.00		- n/a -	20.00
TOTAL:					\$194.00

PAYMENT INFORMATION			
1	AMOUNT:	194.00	POSTMARKED: N/A
	TYPE:	CHECK	RECEIVED: 03/17/2014
	CHECK NO:	1607	
	NAME:	GRE INC 2091 MURRAY HOLLADAY RD STE 22 SALT LAKE CITY UT 84117-5174 US	

REMARKS

This receipt was generated by the automated BLM Collections and Billing System and is a paper representation of a portion of the official electronic record contained therein.

NOTICE!!

These documents have been scanned!

Do not place un-scanned documents beneath this notice!

Do not remove this notice from this file!

GPO Jacket No. 560-102
Print Order 61540
Rise Business Services, LLC
Job=AZ15 6/24/2019



Box Number= AZ15128



Claim Begin-End: AMC427582-AMC427582

2 Correspondence



AZ15128-10

AMC427444-AMC427733

SENDER: COMPLETE THIS SECTION

- Complete items 1, 2, and 3.
- Print your name and address on the reverse so that we can return the card to you.
- Attach this card to the back of the mailpiece, or on the front if space permits.

1. Article Addressed to:

JOE V SCHMOTTER
 617 OLIVE ST W
 STILLWATER, MN 55082-7023
 9200/RM/AMC427582



9590 9402 2832 7069 7541 82

2. Article Number (Transfer from service label)

7017 0660 0000 3024 1218

COMPLETE THIS SECTION ON DELIVERY

A. Signature

X

 Agent Addressee

B. Received by (Printed Name)

C. Date of Delivery

 D. Is delivery address different from item 1? Yes
 If YES, enter delivery address below: No

3. Service Type

- Adult Signature
- Adult Signature Restricted Delivery
- Certified Mail®
- Certified Mail Restricted Delivery
- Collect on Delivery
- Collect on Delivery Restricted Delivery
- Mail
- Mail Restricted Delivery
- (over \$500)

 Priority Mail Express® Registered Mail™ Registered Mail Restricted Delivery Return Receipt for Merchandise Signature Confirmation™ Signature Confirmation Restricted Delivery

USPS TRACKING #

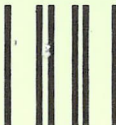

First-Class Mail
Postage & Fees Paid
USPS
Permit No. G-10

9590 9402 2832 7069 7541 82

United States
Postal Service

RECEIVED
BLM AZ STATE OFFICE

• Sender: Please print your name, address, and ZIP+4® in this box •
U.S. DEPARTMENT OF THE INTERIOR
BUREAU OF LAND MANAGEMENT
ARIZONA STATE OFFICE
ONE NORTH CENTRAL AVENUE, SUITE 800
PHOENIX, AZ 85004-4427

2011 OCT 31 P 100 10Z

PHOENIX, AZ

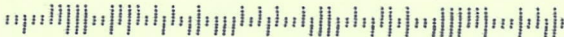



United States Department of the Interior

BUREAU OF LAND MANAGEMENT

Arizona State Office

One North Central Avenue, Suite 800

Phoenix, Arizona 85004-4427

www.blm.gov/az/



OCT 20 2017

In Reply Refer To:

3800 (9200) RM

AMC427582

CERTIFIED MAIL - RETURN RECEIPT REQUESTED No. 7017 0660 0000 3024 1218

NOTICE

JOE V SCHMOTTER : This Notice Affects Those Claims
617 OLIVE ST W : Shown in the Block Below.
STILLWATER, MN 55082-7023 :

AMC427582
NELLIE MEDA

Maintenance Fee Waiver Held for Rejection

This office received the Maintenance Fee Waiver Certification (waiver) for the above listed mining claim(s). The waiver is not properly completed and does not meet the annual filing requirements.

In accordance with 43 Code of Federal Regulations (CFR) 3835.10, the name, address, and original signatures of all owners of the mining claim must be included on the waiver form. Please correct the discrepancy as noted below:

- The document is missing signatures. Next to each name there must be a signature: either that of the owner, or an authorized agent. Please obtain the missing signatures on the enclosed copy of the waiver.
- If an agent signs, they should identify themselves as signing on behalf of an owner, and a Power of Attorney must accompany the waiver document. The execution date on the Power of Attorney must be current within 3 years.

In order to correct the defect in the waiver, per 43 CFR 3835.93, you must provide this office with the requested information within 60 days of your receipt of this notice. If you are unable to provide this information, you have the option of paying the annual maintenance fee of \$155 per claim (\$155

per 20 acres for placer claims larger than 20 acres). If we do not receive the requested corrections or the maintenance fees within the 60 day time frame, the claim(s) will be declared forfeited and closed.

If additional information is required, please contact RéAnn Myers at 602-417-9413. Please include your AMC serial number(s) on all correspondence.

Sincerely,

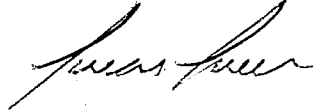

Lucas Lucero
Deputy State Director
Lands, Minerals and Energy Division

Enclosure(s)

USPS Tracking® Results

FAQs > (<http://faq.usps.com/?articleId=220900>)

Track Another Package +

Remove X

Tracking Number: 70170660000030241218



Product & Tracking Information

See Available Actions

Postal Product:

Features:
Certified Mail™

DATE & TIME	STATUS OF ITEM	LOCATION
October 27, 2017, 2:29 pm	Delivered	STILLWATER, MN 55082
Your item was delivered at 2:29 pm on October 27, 2017 in STILLWATER, MN 55082.		
October 27, 2017, 9:43 am	Available for Pickup	STILLWATER, MN 55082
October 26, 2017, 12:52 pm	Notice Left (No Authorized Recipient Available)	STILLWATER, MN 55082
October 26, 2017, 8:06 am	Out for Delivery	STILLWATER, MN 55082

See More ∨

Available Actions

Text & Email Updates



See Less ^

Can't find what you're looking for?

Go to our FAQs section to find answers to your tracking questions.

FAQs (<http://faq.usps.com/?articleId=220900>)



Thrower, Amy <athrower@blm.gov>

Claimant Name

1 message

Santillan, Sonia <ssantill@blm.gov>
To: "Thrower, Amy F" <athrower@blm.gov>

Mon, Jun 20, 2016 at 8:53 AM

Hi Amy

I noticed that the mining claim name data base had a Joe Schmotter in NV and a Joel V. Schmotter in AZ (AMC427582). I called Mr. Schmotter to try to find out if both were the same claimant and he verified that they are both him and that he would prefer the claim in AZ to be listed under Joe Schmotter because he had already submitted a plan of operations in NV under Joe and did not want to do anything that might mess that up. So, could you please have someone place a copy of this email in the case file so that it shows why his name was changed from Joel V to Joe. Please let me know if you would like me to consolidate the names in the name data base or if you will also have someone do that in addition to adding the proper code in LR2000.

Please let me know if you have any questions.

Thank you!

Sonia I. Santillan

Mineral Leasing Specialist
Mining Claims National Data Steward
WO-320 Division of Solid Minerals
(202) 912-7123 (Office)
(703) 691-3542 (Telework)
(202) 912-7199 FAX

"There can be no real and abiding happiness without sacrifice. Our greatest joys do not result from our efforts toward self-gratification, but from a loving and spontaneous service to other lives. Joy comes not to him who seeks it for himself, but to him who seeks it for other people." – H. W. Sylvester

NOTICE!!

These documents have been scanned!

Do not place un-scanned documents beneath this notice!

Do not remove this notice from this file!

GPO Jacket No. 560-102
Print Order 61540
Rise Business Services, LLC
Job=AZ15 6/24/2019



Box Number= AZ15128



Claim Begin-End: AMC427582-AMC427582

3 Transfers



AZ15128-10

AMC427444-AMC427733



GOLD RUSH EXPEDITIONS

When Recorded Mail To:
GRE Inc
2091 E Murray Holladay Road
Suite 22E
SLC, UT 84117

427582

Quit Claim Deed

Quit Claim Deed Exempt Per ARS 11-1134 A6

THE GRANTOR(S): GRE, Inc., of the City of Salt Lake, County of Salt Lake, State of Utah, 84117

For and in consideration \$5,656.00 (Five Thousand Six Hundred Fifty-Six Dollars and Zero Cents), do CONVEY and QUIT CLAIM to:

THE GRANTEE(S):

- Joel V. Schmotter of 617 W. Olive St., in the city Stillwater, county of Washington, state of MN 55082,

In the form of Sole Ownership, all interest in the following described Mining Claim Property(s) situated in the County of Yavapai, in the State of Arizona, to wit:

- Nellie Meda, AMC #427582 Located in sec. 19, Township 8N, Range 8W

Hereby releasing and waiving all rights under and by virtue of the Mining and Location laws of the State of Arizona.

Dated this 27th day of May, 2016

Signature(s) of Grantor(s):

Jessica Shuman GRE, Inc. Representative

RECEIVED
BLM AZ STATE OFFICE
PHOENIX, ARIZONA
2016 JUN - 7 P 2:55

Name & Address of Preparer: **JESSICA SHUMAN, an Agent for GRE, Inc.**
2091 E. Murray Holladay Road #22E- SLC, Utah 84117

SIGNED
Signature of Claim owner's agent Jessica Shuman

BY JESSICA SHUMAN
Printed name of Claim owner's agent
STATE OF UTAH
COUNTY OF SALT LAKE

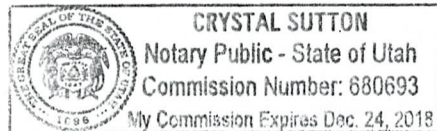

On the 27th day of May, 2016, JESSICA SHUMAN did personally appear before me, the Undersigned notary public in and for the County of Salt Lake, in said State of Utah, Who acknowledged to me that he/she signed it freely and voluntarily for the purposes therein mentioned?

Notary Public of Salt Lake County, Utah

My commission expires on: December 24, 2018

ENTERED
JUN - 9 2016
BY:

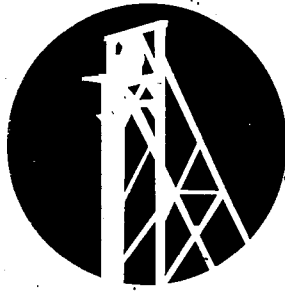

GOLD RUSH
EXPEDITIONS

RECEIVED
BLM ARIZONA STATE OFFICE
2016 JUN 9 P 2:54
PHOENIX, ARIZONA

GRE, Inc.
2091 E. Murray Holladay Road
Suite #22E
SLC, UT 84117

ARIZONA BLM

Re: ONE QUIT CLAIM DEED(s)

Dear ARIZONA BLM Cashier,

Please find enclosed ONE QUIT CLAIM DEED (s) for filing. I understand there is a fee for recording each of these documents. I have enclosed a check for the fees. Please apply the appropriate amount owed for filing fees and send a receipt with the recorded documents.

I have also enclosed a postage paid envelope for the document(s) to be returned.

Thank you for your time and efforts.

Sincerely,

GRE Accounting
385-218-2138
accounting@goldrushexpeditions.com
www.goldrushexpeditions.com

United States Department of the Interior
Bureau of Land Management
 DIV OF LANDS, MINRLS & ENERGY
 ONE N CENTRAL AVE
 PHOENIX, AZ 85004 -4427
 Phone: 602-417-9200

Receipt

No: 3581307

Transaction #: 3684309	
Date of Transaction: 06/08/2016	
CUSTOMER:	
	GRE INC 2091 E MURRAY HOLLADAY RD STE SALT LAKE CITY,UT 84117-5174 US

LINE #	QTY	DESCRIPTION	REMARKS	UNIT PRICE	TOTAL
1	1.00	LOCATABLE MINERALS / MINING CLAIMS- NOT NEW-UNADJUD,ONE AUTH NO. ONLY / MINING CLAIM MONEY RECEIVED CASES: AMC427582/\$10.00	QCD - 1	- n/a -	10.00
TOTAL:					\$10.00

PAYMENT INFORMATION					
1	AMOUNT:	10.00	POSTMARKED:	06/04/2016	
	TYPE:	CHECK	RECEIVED:	06/07/2016	
	CHECK NO:	002886			
	NAME:	GRE INC 2091 E MURRAY HOLLADAY RD STE SALT LAKE CITY UT 84117-5174 US			

REMARKS

This receipt was generated by the automated BLM Collections and Billing System and is a paper representation of a portion of the official electronic record contained therein.

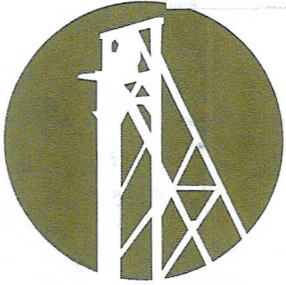

GOLD RUSH
EXPEDITIONS
2091 E. MURRAY HOLLADAY RD, STE. 22E
SALT LAKE CITY, UTAH 84117

SALT LAKE UT 841
SAT 04 JUN 2016 PM



\$1.578 US POSTAGE
FIRST CLASS
PERMIT NO. 4117
SALT LAKE CITY UT

Arizona BLM
Attn: Cashier
One N. Central Ave., Ste. 800
Phoenix, AZ 85004

RECEIVED
JUN 7 2015
PHOENIX, ARIZONA

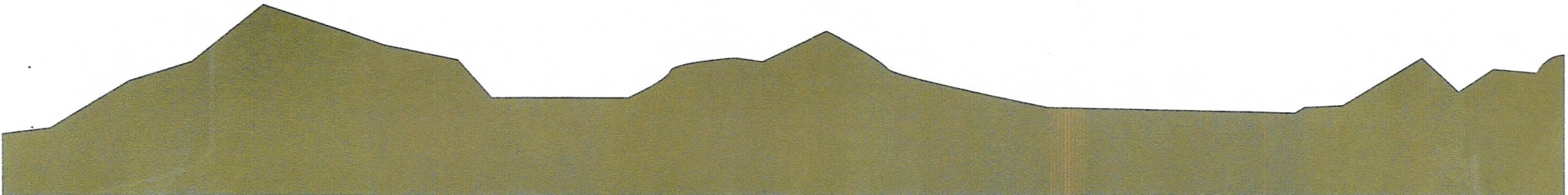

NOTICE!!

These documents have been scanned!

Do not place un-scanned documents beneath this notice!

Do not remove this notice from this file!

GPO Jacket No. 560-102
Print Order 61540
Rise Business Services, LLC
Job=AZ15 6/24/2019



Box Number= AZ15128



Claim Begin-End: AMC427582-AMC427582

4 Annual Filings



AZ15128-10

AMC427444-AMC427733

UNITED STATES
DEPARTMENT OF THE INTERIOR
BUREAU OF LAND MANAGEMENT

FORM APPROVED
OMB NO.: 1004-0114
Expires: January 31, 2020

AFFIDAVIT OF ANNUAL ASSESSMENT WORK

417513

427582

WHEN RECORDED, MAIL DOCUMENT TO:

NAME: Joe Schmotter

ADDRESS: 617 West Olive Street

CITY, STATE, ZIP: Stillwater, MN 55082

FOR COUNTY RECORDER'S USE

No. of Claims 1

x \$10/claim

Total due BLM \$ 10

TO ALL WHOM IT MAY CONCERN:

Rec. 4247567 &

1. The undersigned certifies that at least \$100 per claim was expended for development, labor and improvements, or equivalent value added, as the annual assessment work for the assessment year ending September 1, 2018 for the following contiguous unpatented mining claim(s), located in the County of MOHAVE, in the State of ARIZONA.

BLM Serial No.	Name of Claim	Tp Rg Sec Mer				County Recordation Book and Page No.	Co. Recording Date
		Example: 13N 5E 14 MDM					
AMC417513	PARAGON MINE	18N	20W	3	GSR	2018 005860	02/07/2018

RECEIVED
 BLM AZ STATE OFFICE
 2018 AUG 27 P 2 43
 PHOENIX, ARIZONA

(Continued on page 2)

ENTERED
 AUG 29 2018
 BY: KAM

2. Type of labor and improvements (specify what was done and give the total value for that labor and improvement to show at least \$100 for each claim). If a geological, geochemical, or geophysical survey was performed, as per 30 U.S.C. 28-1, reference the title of the report of survey, give cost and date of the survey and report, and indicate it was filed with the County Recorder:

Description of Work Performed	Value of Work Performed	Date Work Was Performed
-SITE CLEAN UP/ JUNK REMOVAL	\$200	JUNE 11, 2018

3. Name and mailing address of each person who performed the labor and improvements:

Name (please print)
 JOE SCHMOTTER

Current Mailing Address (please print)
 617 WEST OLIVE STREET

STILLWATER, MN 55082

4. Name and mailing address of each person who holds and claims the subject mining claim(s) for the valuable minerals contained therein. Be sure to indicate if there is a change of address:

Name (please print)
 JOE SCHMOTTER

Current Mailing Address (please print)
 617 WEST OLIVE STREET

STILLWATER MN, 55082

RECEIVED
 BLM AZ STATE OFFICE
 2018 AUG 21 P 2:43
 PHOENIX, ARIZONA

5. The undersigned testifies that on the date of AUGUST 21, 2018, all monuments required by law were erected upon the subject claim(s), and all notices required by law were posted on the subject claim(s) or copies thereof were in place, and at said date, each corner monument bore or contained

markings sufficient to appropriately designate the corner of the claim to which it pertains and the name of the claim(s).

I hereby certify under penalty of perjury under the laws of the State of ARIZONA that the foregoing statements are true and correct:

[Signature] Date: 8-27-18
(Signature of person responsible for above statement)

Title 18 U.S.C. 1001 and 43 U.S.C. 1212 make it a crime for any person knowingly and willfully to make to any department or agency of the United States any false, fictitious or fraudulent statements or representations as to any matter within its jurisdiction.

Notary Block

SUBSCRIBED AND SWORN TO before me, this 22 day of August 2018

By: [Signature]
(Signature of Affiant)

Title: Notary Public

My Commission Expires: 01/31/2022

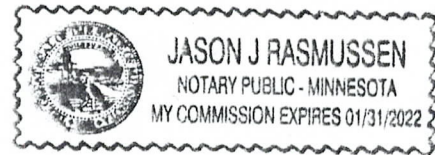

INSTRUCTIONS

1. This is an optional form that may be used to satisfy the requirements for the Bureau of Land Management (BLM) under the provisions of 43 U.S.C. §1744 and 30 U.S.C. §28-28d and the regulations thereunder (43 CFR part 3835). Since local and State laws may vary, you should contact your local and State agencies where the claims are located to ensure all applicable laws and requirements are satisfied.
2. The claimant(s) must fill in the date in paragraph 1 for the applicable assessment year and the county and state where the claims are located.
3. All claim names, BLM serial numbers, legal descriptions, and original county recording information must be listed for the claims pertaining to this assessment notice.
4. The claimant(s) must complete paragraph 2 listing all labor or improvements which was performed on or did benefit the subject mining claims. The value and date of the labor or improvements must also be listed. The total amount of labor or improvements can be listed, but the total expenditure must equal at least \$100 for each claim.
5. The names and current mailing addresses of the person(s) performing the labor shall be listed in paragraph 3.
6. The name and current mailing address of each owner (claimant) of the claims shall be listed in paragraph 4. The mailing address shall be the owner's address and not the address of an agent or anyone representing the claimant. Be sure to note if there has been a change of address.
7. Paragraph 5 shall be completed to show the date it was verified that all monuments required by law were properly erected, all notices were posted, and that corners were appropriately designated for all claims listed.
8. An exact legible reproduction or duplicate (other than microfilm or other electronic media) of this affidavit or another type of affidavit of assessment work that you file or will file in the county where each claim is located, must be filed with the BLM on or before December 30 of the calendar year in which the assessment year ends. For mill or tunnel sites, a separate notice of intent to hold must be filed with the BLM on or before December 30. Requirements for filing a notice of intent to hold can be found at 43 CFR 3835.33.
9. A processing fee of \$10 for each claim listed must be remitted to the BLM along with this or any other affidavit of assessment work.

UNITED STATES
DEPARTMENT OF THE INTERIOR
BUREAU OF LAND MANAGEMENT

FORM APPROVED
OMB NO.: 1004-0114
Expires: January 31, 2020

AFFIDAVIT OF ANNUAL ASSESSMENT WORK

WHEN RECORDED, MAIL DOCUMENT TO:

NAME: Joe Schmotter

ADDRESS: 617 West Olive Street

CITY, STATE, ZIP: Stillwater, MN 55082

FOR COUNTY RECORDER'S USE

No. of Claims 1

x \$10/claim

Total due BLM \$ 10

TO ALL WHOM IT MAY CONCERN:

Rec. 4247567 ea

1. The undersigned certifies that at least \$100 per claim was expended for development, labor and improvements, or equivalent value added, as the annual assessment work for the assessment year ending September 1, 2018 for the following contiguous unpatented mining claim(s), located in the County of YAVAPAI, in the State of ARIZONA.

BLM Serial No.	Name of Claim	Tp Rg Sec Mer				County Recordation Book and Page No.	Co. Recording Date
		Example: 13N 5E 14 MDM					
AMC427582	NELLIE MEDA	8N	8W	19	GSR	2016-0026966	06/07/2016

RECEIVED
 BLM AZ STATE OFFICE
 2018 AUG 27 P 2:43
 PHOENIX, ARIZONA

2. Type of labor and improvements (specify what was done and give the total value for that labor and improvement to show at least \$100 for each claim). If a geological, geochemical, or geophysical survey was performed, as per 30 U.S.C. 28-1, reference the title of the report of survey, give cost and date of the survey and report, and indicate it was filed with the County Recorder:

Description of Work Performed	Value of Work Performed	Date Work Was Performed
SAMPLING-ASSAY-SITE CLEAN UP	\$300	FEB 8-11, 2018

3. Name and mailing address of each person who performed the labor and improvements:

Name (please print)
JOE SCHMOTTER

Current Mailing Address (please print)
617 WEST OLIVE STREET
STILLWATER, MN 55082

4. Name and mailing address of each person who holds and claims the subject mining claim(s) for the valuable minerals contained therein. Be sure to indicate if there is a change of address:

Name (please print)
JOE SCHMOTTER

Current Mailing Address (please print)
617 WEST OLIVE STREET
STILLWATER MN, 55082

RECEIVED
 BLM AZ STATE OFFICE
 2018 AUG 27 P 2:43
 PHOENIX ARIZONA

5. The undersigned testifies that on the date of AUGUST 21, 2018, all monuments required by law were erected upon the subject claim(s), and all notices required by law were posted on the subject claim(s) or copies thereof were in place, and at said date, each corner monument bore or contained

markings sufficient to appropriately designate the corner of the claim to which it pertains and the name of the claim(s).

I hereby certify under penalty of perjury under the laws of the State of ARIZONA that the foregoing statements are true and correct:

Joe Schmitter Date: 8-22-18
(Signature of person responsible for above statement)

Title 18 U.S.C. 1001 and 43 U.S.C. 1212 make it a crime for any person knowingly and willfully to make to any department or agency of the United States any false, fictitious or fraudulent statements or representations as to any matter within its jurisdiction.

Notary Block

SUBSCRIBED AND SWORN TO before me, this 22 day of August 20 18

By: Jason J Rasmussen
(Signature of Affiant)

Title: Notary Public

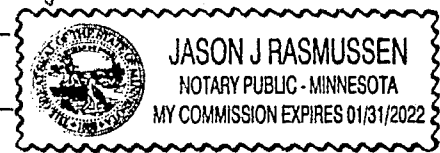

My Commission Expires: 01/31/2022

INSTRUCTIONS

1. This is an optional form that may be used to satisfy the requirements for the Bureau of Land Management (BLM) under the provisions of 43 U.S.C. §1744 and 30 U.S.C. §28-28d and the regulations thereunder (43 CFR part 3835). Since local and State laws may vary, you should contact your local and State agencies where the claims are located to ensure all applicable laws and requirements are satisfied.
2. The claimant(s) must fill in the date in paragraph 1 for the applicable assessment year and the county and state where the claims are located.
3. All claim names, BLM serial numbers, legal descriptions, and original county recording information must be listed for the claims pertaining to this assessment notice.
4. The claimant(s) must complete paragraph 2 listing all labor or improvements which was performed on or did benefit the subject mining claims. The value and date of the labor or improvements must also be listed. The total amount of labor or improvements can be listed, but the total expenditure must equal at least \$100 for each claim.
5. The names and current mailing addresses of the person(s) performing the labor shall be listed in paragraph 3.
6. The name and current mailing address of each owner (claimant) of the claims shall be listed in paragraph 4. The mailing address shall be the owner's address and not the address of an agent or anyone representing the claimant. Be sure to note if there has been a change of address.
7. Paragraph 5 shall be completed to show the date it was verified that all monuments required by law were properly erected, all notices were posted, and that corners were appropriately designated for all claims listed.
8. An exact legible reproduction or duplicate (other than microfilm or other electronic media) of this affidavit or another type of affidavit of assessment work that you file or will file in the county where each claim is located, must be filed with the BLM on or before December 30 of the calendar year in which the assessment year ends. For mill or tunnel sites, a separate notice of intent to hold must be filed with the BLM on or before December 30. Requirements for filing a notice of intent to hold can be found at 43 CFR 3835.33.
9. A processing fee of \$10 for each claim listed must be remitted to the BLM along with this or any other affidavit of assessment work.

Joe Sch
617 West C
Stillwater, MN

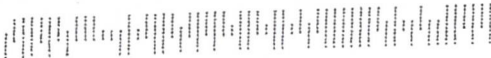

U.S. POSTAGE PAID
FCM LETTER
STILLWATER, MN
55082
AUG 23, 18
AMOUNT

\$4.16

R2304N118584-03

1024

85004

Rach...

THU 23 AUG 2018



BLM ARIZONA STATE OFFICE
1 N CENTRAL AVE.
SUITE 800
PHOENIX AZ, 85004

RECEIVED
BLM AZ STATE OFFICE
2018 AUG 27 P 2:42
PHOENIX, ARIZONA

United States Department of the Interior
Bureau of Land Management
 DIV OF LANDS, MINRLS & ENERGY
 ONE N CENTRAL AVE
 PHOENIX, AZ 85004 -4427
 Phone: 602-417-9200

Receipt

No: 4247567

Transaction #: 4363038	
Date of Transaction: 08/28/2018	
CUSTOMER:	
JOE SCHMOTTER 617 OLIVE ST W STILLWATER, MN 55082-7023 US	

LINE #	QTY	DESCRIPTION	REMARKS	UNIT PRICE	TOTAL
1	1.00	LOCATABLE MINERALS / MINING CLAIMS- NOT NEW-UNADJUD, ONE AUTH NO. ONLY / MINING CLAIM MONEY RECEIVED CASES: AMC417513/\$20.00	2018 POL & 2019 WAIV (2)	- n/a -	20.00
TOTAL:					\$20.00

PAYMENT INFORMATION					
1	AMOUNT:	20.00	POSTMARKED:	N/A	
	TYPE:	CHECK	RECEIVED:	08/27/2018	
	CHECK NO:	1101			
	NAME:	SCHMOTTER, JOE 617 OLIVE ST W STILLWATER MN 55082-7023 US			

REMARKS

This receipt was generated by the automated BLM Collections and Billing System and is a paper representation of a portion of the official electronic record contained therein.

UNITED STATES
DEPARTMENT OF THE INTERIOR
BUREAU OF LAND MANAGEMENT
MAINTENANCE FEE WAIVER CERTIFICATION

402

EPG

417513
427582

FORM APPROVED
OMB NO. 1004-0114
Expires: January 31, 2020

SEE INSTRUCTIONS ON PAGE 2

- This small miner waiver is filed for the assessment year beginning on September 1, 2018 and ending on September 1, 2019.
- The undersigned and all related parties owned ten or fewer mining claims, mill, or tunnel sites located and maintained on Federal lands in the United States of America on September 1, 2018.
- The undersigned have performed the assessment work required by law for each mining claim listed prior to filing this waiver and understand that by filing this form, the undersigned must file an affidavit of assessment work with the Bureau of Land Management (BLM) by the December 30th following the filing of this waiver.
- The undersigned understand that if the assessment work obligation has not yet come due under 30 U.S.C. 28 (for those claims in their first assessment year only), a notice of intent to hold reciting this condition must be recorded by the December 30th following the filing of this waiver.
- The undersigned understand that mill and tunnel sites may also be listed on this waiver and be waived from payment of the maintenance fee, and that a notice of intent to hold for these sites is required to be filed with the BLM by the December 30th following the filing of this waiver.
- The undersigned understand and acknowledge that pursuant to 43 U.S.C. 1212 and 18 U.S.C. 1001, the filing or recording of a false, fictitious, or fraudulent document with the BLM may result in a fine of up to \$250,000, a prison term not to exceed five years, or both.
- The mining claims, mill or tunnel sites for which this waiver from payment of the maintenance fees is requested are:

CLAIM OR SITE NAME	BLM RECORDATION SERIAL NUMBER
1. PARAGON MINE	AMC417513 (913)
2. NELLIE MEDA	AMC427582
3.	
4.	
5.	
6.	
7.	
8.	
9.	
10.	

RECEIVED
BLM AZ STATE OFFICE
2018 AUG 27 P 2:42
PHOENIX, ARIZONA

The owner(s) (claimants) of the above mining claims and sites are:

JOE SCHMOTTER

(Owner's Name - Please Print)

617 WEST OLIVE STREET

(Owner's Mailing Address)

Joe Schmotter
(Owner's Signature)

STILLWATER

(City)

MN

(State)

55082

(Zip Code)

(Owner's Name - Please Print)

(Owner's Mailing Address)

(Owner's Signature)

(City)

(State)

(Zip Code)

(Owner's Name - Please Print)

(Owner's Mailing Address)

(Owner's Signature)

(City)

(State)

(Zip Code)

(Owner's Name - Please Print)

(Owner's Mailing Address)

(Owner's Signature)

(City)

(State)

(Zip Code)

(Continued on page 2)

ENTERED
SEP 05 2018
BY: *EPG*

(Owner's Name - Please Print)	(Owner's Signature)		
(Owner's Mailing Address)	(City)	(State)	(Zip Code)
(Owner's Name - Please Print)	(Owner's Signature)		
(Owner's Mailing Address)	(City)	(State)	(Zip Code)
(Owner's Name - Please Print)	(Owner's Signature)		
(Owner's Mailing Address)	(City)	(State)	(Zip Code)
(Owner's Name - Please Print)	(Owner's Signature)		
(Owner's Mailing Address)	(City)	(State)	(Zip Code)

18 U.S.C. 1001 and 43 U.S.C. 1212 make it a crime for any person knowingly and willfully to make to any department or agency of the United States any false, fictitious or fraudulent statements or representations as to any matter within its jurisdiction.

INSTRUCTIONS

1. This certification is made under the provisions of 43 U.S.C. § 1744 and 30 U.S.C. §28-28k and the regulations thereunder (43 CFR Part 3830).
2. The claimant(s) must fill in the dates in paragraph 1 for the beginning and ending of the assessment year for which this waiver is sought.
3. The claimant(s) must fill in the date in paragraph 2 for the beginning of the assessment year for which this waiver is sought.
4. All claim and site names and BLM serial numbers must be listed for the mining claims, mill sites, and tunnel sites for which the waiver is sought.
5. All owners of the mining claims, mill sites, and tunnel sites and their addresses must be given.
6. This waiver form must be signed by all the claimants or their designated agent, in original form. If an agent is designated, a notarized designation of agent, signed by all of the claimants with proper address given, must be submitted with this waiver.
7. This form must be filed no later than September 1st for the upcoming assessment year in the BLM State Office where the mining claims or sites are recorded, or the waiver cannot be granted by the BLM. (Example: To obtain a waiver for the assessment year 2012, which begins on September 1, 2011, you must qualify for and file for a waiver no later than September 1, 2011, in the proper BLM State Office.)
8. For all mining claims which require assessment work, you must record an affidavit of labor on or before the December 30th immediately following the filing of this waiver. For all other mining claims or sites waived, you must record a notice of intent to hold on or before the December 30th immediately following the filing of this waiver.
9. Mill and tunnel sites may also be listed on this waiver and be waived from payment of the maintenance fee. A notice of intent to hold for these sites is required to be filed by the December 30th following the filing of this waiver.

PHOENIX, ARIZONA

2010 AUG 27 P 2:42

RECEIVED

BLM STATE OFFICE

FOR OFFICIAL USE ONLY

UNITED STATES
DEPARTMENT OF THE INTERIOR
BUREAU OF LAND MANAGEMENT

MAINTENANCE FEE WAIVER CERTIFICATION

FORM APPROVED
OMB NO. 1004-0114
Expires: January 31, 2020

Amc427582

433

SEE INSTRUCTIONS ON PAGE 2

- This small miner waiver is filed for the assessment year beginning on September 1, 2017 and ending on September 1, 2018.
- The undersigned and all related parties owned ten or fewer mining claims, mill, or tunnel sites located and maintained on Federal lands in the United States of America on September 1, 2017.
- The undersigned have performed the assessment work required by law for each mining claim listed prior to filing this waiver and understand that by filing this form, the undersigned must file an affidavit of assessment work with the Bureau of Land Management (BLM) by the December 30th following the filing of this waiver.
- The undersigned understand that if the assessment work obligation has not yet come due under 30 U.S.C. 28 (for those claims in their first assessment year only), a notice of intent to hold reciting this condition must be recorded by the December 30th following the filing of this waiver.
- The undersigned understand that mill and tunnel sites may also be listed on this waiver and be waived from payment of the maintenance fee, and that a notice of intent to hold for these sites is required to be filed with the BLM by the December 30th following the filing of this waiver.
- The undersigned understand and acknowledge that pursuant to 43 U.S.C. 1212 and 18 U.S.C. 1001, the filing or recording of a false, fictitious, or fraudulent document with the BLM may result in a fine of up to \$250,000, a prison term not to exceed five years, or both.
- The mining claims, mill or tunnel sites for which this waiver from payment of the maintenance fees is requested are:

CLAIM OR SITE NAME	BLM RECORDATION SERIAL NUMBER
1. NELLIE MEDA	✓ AMC 427582
2.	
3.	
4.	
5.	
6.	
7.	
8.	
9.	
10.	

RECEIVED
BLM AZ STATE OFFICE
2017 SEP - 1 10:32 AM
PHOENIX, ARIZONA
555082

The owner(s) (claimants) of the above mining claims and sites are:

JOE SCHMOTTER

 (Owner's Name - Please Print)
 617 OLIVE STREET WEST

 (Owner's Mailing Address)

 (Owner's Signature)
 STILLWATER

 (City) _____
 (State) _____
 (Zip Code)

 (Owner's Name - Please Print)

 (Owner's Mailing Address)

 (Owner's Signature)

 (City) _____
 (State) _____
 (Zip Code)

 (Owner's Name - Please Print)

 (Owner's Mailing Address)

 (Owner's Signature)

 (City) _____
 (State) _____
 (Zip Code)

 (Owner's Name - Please Print)

 (Owner's Mailing Address)

 (Owner's Signature)

 (City) _____
 (State) _____
 (Zip Code)

RECEIVED
BLM AZ STATE OFFICE
2017 NOV 27 10:53 AM
PHOENIX, ARIZONA

423 2247
 INTEREST
 SEP 12 2017
 (City)

#3971378

**DEPARTMENT OF THE INTERIOR
BUREAU OF LAND MANAGEMENT
MINING CLAIMS**

(LIVE) Serial Register Page

Run Date/Time: 09/12/2017 01:28 PM

Page 1 of 1

01 05-10-1872;017STAT0091;30USC26,28,34

Case Type 384101: LODE CLAIM

Claim Name: NELLIE MEDA

Commodity :

Case Disposition: ACTIVE

Required Maintenance Fee: \$155.00

Total Acres

20.660

Serial Number

AMC427582

Lead File Number

AMC427582

Name & Address

Int Rel

SCHMOTTER JOE V 617 OLIVE ST W STILLWATER, MN 55082-7023 CLAIMANT

Mer Twp	Rng	Sec	Quadrant	District/Field Office	County
14	0080N	0080W	019	NE,SE	HASSAYAMPA FO
					YAVAPAI

Act Date	Code	Action	Action Remarks	Receipt Number
12/28/2013	403	LOCATION DATE		
03/17/2014	395	RECORDATION NOTICE RECD	1	2991178
08/23/2016	782	MAINTENANCE FEE PAYMENT	2017;\$155	3638895
07/17/2015	782	MAINTENANCE FEE PAYMENT	2016;\$155	3345205
08/13/2014	782	MAINTENANCE FEE PAYMENT	2015;\$155	3101152
03/17/2014	484	LOCATION YEAR / MAINTENANC	2014;\$140	2991178
09/01/2017	392	MONIES RECEIVED	\$10.00;1	3971378
06/07/2016	396	TRF OF INTEREST FILED	GRE INC	3581307
07/01/2014	669	LAND STATUS CHECKED		
03/17/2014	501	ACCT ADV IN LEAD FILE	AMC427582;	

Line Nr Remarks

RECEIVED
BLM AZ STAFF OFFICE
2017 NOV 27 P 3:53
PHOENIX, ARIZONA

NO WARRANTY IS MADE BY BLM
FOR USE OF THE DATA FOR
PURPOSES NOT INTENDED BY BLM

Sorry for the
oversite

Joe

12/2/2001

12/2/2001



United States Department of the Interior

BUREAU OF LAND MANAGEMENT
Arizona State Office
One North Central Avenue, Suite 800
Phoenix, Arizona 85004-4427
www.blm.gov/az/



RECEIVED
BLM AZ STATE OFFICE
2017 NOV 27 P 3:52
PHOENIX, ARIZONA

OCT 20 2017

In Reply Refer To:
3800 (9200) RM
AMC427582

CERTIFIED MAIL - RETURN RECEIPT REQUESTED No. 7017 0660 0000 3024 1218

NOTICE

JOE V SCHMOTTER : This Notice Affects Those Claims
617 OLIVE ST W : Shown in the Block Below.
STILLWATER, MN 55082-7023 :

AMC427582
NELLIE MEDA

Maintenance Fee Waiver Held for Rejection

This office received the Maintenance Fee Waiver Certification (waiver) for the above listed mining claim(s). The waiver is not properly completed and does not meet the annual filing requirements.

In accordance with 43 Code of Federal Regulations (CFR) 3835.10, the name, address, and original signatures of all owners of the mining claim must be included on the waiver form. Please correct the discrepancy as noted below:

- The document is missing signatures. Next to each name there must be a signature: either that of the owner, or an authorized agent. Please obtain the missing signatures on the enclosed copy of the waiver.
- If an agent signs, they should identify themselves as signing on behalf of an owner, and a Power of Attorney must accompany the waiver document. The execution date on the Power of Attorney must be current within 3 years.

In order to correct the defect in the waiver, per 43 CFR 3835.93, you must provide this office with the requested information within 60 days of your receipt of this notice. If you are unable to provide this information, you have the option of paying the annual maintenance fee of \$155 per claim (\$155

per 20 acres for placer claims larger than 20 acres). If we do not receive the requested corrections or the maintenance fees within the 60 day time frame, the claim(s) will be declared forfeited and closed.

If additional information is required, please contact RéAnn Myers at 602-417-9413. Please include your AMC serial number(s) on all correspondence.

Sincerely,

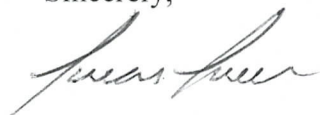

Lucas Lucero
Deputy State Director
Lands, Minerals and Energy Division

Enclosure(s)

RECEIVED
BLM AZ STATE OFFICE
2011 NOV 21 P 3:53
PHOENIX, ARIZONA

Joe Schmitter
617 W. Olive St.
Stillwater Mn.
55082



7017 0190 0001 1451 1714



1024



85004

U.S. POSTAGE
PAID
STILLWATER, MN
55082
NOV 22, 17
AMOUNT

\$3.84

R2303S102481-04

US Dept. of Interior
BLM

One North Central Ave., Suite 800
Phoenix AZ

90001 11177



PLACE STICKER AT TOP OF ENVELOPE TO THE RIGHT
OF THE RETURN ADDRESS. FOLD AT DOTTED LINE

CERTIFIED MAIL®

UNITED STATES
DEPARTMENT OF THE INTERIOR
BUREAU OF LAND MANAGEMENT
MAINTENANCE FEE WAIVER CERTIFICATION

[Handwritten signature]

433

Amc427582

FORM APPROVED
OMB NO. 1004-0114
Expires: January 31, 2020

SEE INSTRUCTIONS ON PAGE 2

1. This small miner waiver is filed for the assessment year beginning on September 1, 2017 and ending on September 1, 2018.
2. The undersigned and all related parties owned ten or fewer mining claims, mill, or tunnel sites located and maintained on Federal lands in the United States of America on September 1, 2017.
3. The undersigned have performed the assessment work required by law for each mining claim listed prior to filing this waiver and understand that by filing this form, the undersigned must file an affidavit of assessment work with the Bureau of Land Management (BLM) by the December 30th following the filing of this waiver.
4. The undersigned understand that if the assessment work obligation has not yet come due under 30 U.S.C. 28 (for those claims in their first assessment year only), a notice of intent to hold reciting this condition must be recorded by the December 30th following the filing of this waiver.
5. The undersigned understand that mill and tunnel sites may also be listed on this waiver and be waived from payment of the maintenance fee, and that a notice of intent to hold for these sites is required to be filed with the BLM by the December 30th following the filing of this waiver.
6. The undersigned understand and acknowledge that pursuant to 43 U.S.C. 1212 and 18 U.S.C. 1001, the filing or recording of a false, fictitious, or fraudulent document with the BLM may result in a fine of up to \$250,000, a prison term not to exceed five years, or both.
7. The mining claims, mill or tunnel sites for which this waiver from payment of the maintenance fees is requested are:

CLAIM OR SITE NAME	BLM RECORDATION SERIAL NUMBER
1. NELLIE MEDA	✓ AMC 427582
2.	
3.	
4.	
5.	
6.	
7.	
8.	
9.	
10.	

RECEIVED
BLM AZ STATE OFFICE
2017 SEP - 1 P 3:28
PHOENIX, ARIZONA

The owner(s) (claimants) of the above mining claims and sites are:

JOE SCHMOTTER

(Owner's Name - Please Print)

617 OLIVE STREET WEST

(Owner's Mailing Address)

(Owner's Signature)

STILLWATER

(City)

(State)

(Zip Code) 55082

(Owner's Name - Please Print)

(Owner's Signature)

(Owner's Mailing Address)

(City)

(State)

(Zip Code)

(Owner's Name - Please Print)

(Owner's Signature)

(Owner's Mailing Address)

(City)

(State)

(Zip Code)

(Owner's Name - Please Print)

(Owner's Signature)

(Owner's Mailing Address)

(City)

(State)

(Zip Code)

(Continued on page 2)

INTERESTED
SEP 12 2017

247 REMOVED - CORRECTED
WAIVER REV'D 11/27/2017, PA

#3971378

[Handwritten initials]

UNITED STATES
DEPARTMENT OF THE INTERIOR
BUREAU OF LAND MANAGEMENT

FORM APPROVED
OMB NO.: 1004-0114
Expires: January 31, 2020

427582

AFFIDAVIT OF ANNUAL ASSESSMENT WORK

WHEN RECORDED, MAIL DOCUMENT TO:

NAME: JOE SCHMOTTER

ADDRESS: 617 WEST OLIVE STREET

CITY, STATE, ZIP: STILLWATER, MN 55082

FOR COUNTY RECORDER'S USE

No. of Claims 1
x \$10/claim
Total due BLM \$ \$10.00

TO ALL WHOM IT MAY CONCERN:

1. The undersigned certifies that at least \$100 per claim was expended for development, labor and improvements, or equivalent value added, as the annual assessment work for the assessment year ending September 1, 2017 for the following contiguous unpatented mining claim(s), located in the County of YAVAPAI, in the State of ARIZONA.

BLM Serial No.	Name of Claim	Tp Rg Sec Mer				County Recordation Book and Page No.	Co. Recording Date
		Example: 13N 5E 14 MDM					
AMC 427582	NELLIE MEDA	8N	8W	19	GSR	2016-0026966	06/07/2016

RECEIVED
BLM AZ STATE OFFICE
2017 SEP -1 P 3 20
PHOENIX, ARIZONA

ENTERED
SEP 14 2017
RSM

2. Type of labor and improvements (specify what was done and give the total value for that labor and improvement to show at least \$100 for each claim). If a geological, geochemical, or geophysical survey was performed, as per 30 U.S.C. 28-1, reference the title of the report of survey, give cost and date of the survey and report, and indicate it was filed with the County Recorder:

Description of Work Performed	Value of Work Performed	Date Work Was Performed
SITE CLEANUP	\$200	MAY10-20, 2017

3. Name and mailing address of each person who performed the labor and improvements:

Name (please print)
JOE SCHMOTTER

Current Mailing Address (please print)
617 WEST OLIVE STREET, STILLWATER, MN 55082

4. Name and mailing address of each person who holds and claims the subject mining claim(s) for the valuable minerals contained therein. Be sure to indicate if there is a change of address:

Name (please print)
JOE SCHMOTTER

Current Mailing Address (please print)
617 WEST OLIVE STREET, STILLWATER, MN 55082

RECEIVED
 BLM AL STATE OFFICE
 2011 SEP - 1 P 3:20
 PHOENIX, ARIZONA

5. The undersigned testifies that on the date of AUGUST 28, 2017, all monuments required by law were erected upon the subject claim(s), and all notices required by law were posted on the subject claim(s) or copies thereof were in place, and at said date, each corner monument bore or contained

markings sufficient to appropriately designate the corner of the claim to which it pertains and the name of the claim(s).

I hereby certify under penalty of perjury under the laws of the State of ARIZONA that the foregoing statements are true and correct:

[Signature] Date: 8-29-17
(Signature of person responsible for above statement)

Title 18 U.S.C. 1001 and 43 U.S.C. 1212 make it a crime for any person knowingly and willfully to make to any department or agency of the United States any false, fictitious or fraudulent statements or representations as to any matter within its jurisdiction.

Notary Block

SUBSCRIBED AND SWORN TO before me, this 29th day of August 2017

By: Joel Schreiber / Linda Corbo
(Signature of Affiant)

Title: Notary Public

My Commission Expires: 1-31-2021



INSTRUCTIONS

1. This is an optional form that may be used to satisfy the requirements for the Bureau of Land Management (BLM) under the provisions of 43 U.S.C. §1744 and 30 U.S.C. §28-28d and the regulations thereunder (43 CFR part 3835). Since local and State laws may vary, you should contact your local and State agencies where the claims are located to ensure all applicable laws and requirements are satisfied.
2. The claimant(s) must fill in the date in paragraph 1 for the applicable assessment year and the county and state where the claims are located.
3. All claim names, BLM serial numbers, legal descriptions, and original county recording information must be listed for the claims pertaining to this assessment notice.
4. The claimant(s) must complete paragraph 2 listing all labor or improvements which was performed on or did benefit the subject mining claims. The value and date of the labor or improvements must also be listed. The total amount of labor or improvements can be listed, but the total expenditure must equal at least \$100 for each claim.
5. The names and current mailing addresses of the person(s) performing the labor shall be listed in paragraph 3.
6. The name and current mailing address of each owner (claimant) of the claims shall be listed in paragraph 4. The mailing address shall be the owner's address and not the address of an agent or anyone representing the claimant. Be sure to note if there has been a change of address.
7. Paragraph 5 shall be completed to show the date it was verified that all monuments required by law were properly erected, all notices were posted, and that corners were appropriately designated for all claims listed.
8. An exact legible reproduction or duplicate (other than microfilm or other electronic media) of this affidavit or another type of affidavit of assessment work that you file or will file in the county where each claim is located, must be filed with the BLM on or before December 30 of the calendar year in which the assessment year ends. For mill or tunnel sites, a separate notice of intent to hold must be filed with the BLM on or before December 30. Requirements for filing a notice of intent to hold can be found at 43 CFR 3835.33.
9. A processing fee of \$10 for each claim listed must be remitted to the BLM along with this or any other affidavit of assessment work.

RECEIVED
REGISTERED OFFICE
TOMBIX, ARIZONA
SEP - 1 P 3:20

Joe S 
617 W. Olive St.
Stillwater Mn,
55082

RECEIVED
BLM AZ STATE OFFICE

2017 SEP -1 P 3:40

PHOENIX, ARIZONA



1000



85004

U.S. POSTAGE
PAID
STILLWATER, MN
55082
AUG 29, 17
AMOUNT

\$1.19

R2304N118584-03

BLM
Arizona State Office
One N. Central Ave.
Suite 800
Phoenix AZ 85004-4427

A7-

United States Department of the Interior
Bureau of Land Management
 DIV OF LANDS, MINRLS & ENERGY
 ONE N CENTRAL AVE
 PHOENIX, AZ 85004 -4427
 Phone: 602-417-9200

Receipt

No: 3971378

Transaction #: 4081313	
Date of Transaction: 09/05/2017	
CUSTOMER:	
JOE SCHMOTTER 617 OLIVE ST W STILLWATER, MN 55082-7023 US	

LINE #	QTY	DESCRIPTION	REMARKS	UNIT PRICE	TOTAL
1	1.00	LOCATABLE MINERALS / MINING CLAIMS- NOT NEW-UNADJUD, ONE AUTH NO. ONLY / MINING CLAIM MONEY RECEIVED CASES: AMC427582/\$10.00	POL 2017/1 WAV	- n/a -	10.00
TOTAL:					\$10.00

PAYMENT INFORMATION			
1	AMOUNT:	10.00	POSTMARKED: 08/29/2017
	TYPE:	CHECK	RECEIVED: 09/01/2017
	CHECK NO:	1060	
	NAME:	SCHMOTTER, JOEL VICTOR 617 OLIVE ST W STILLWATER MN 55082-7023 US	

REMARKS
* Waiver not signed

This receipt was generated by the automated BLM Collections and Billing System and is a paper representation of a portion of the official electronic record contained therein.

Run Date: 09/09/16

Run Time: 05:54 AM

**DEPARTMENT OF THE INTERIOR
BUREAU OF LAND MANAGEMENT
MINING CLAIMS**

MC Maintenance Fees Paid Through the BLM Pay Portal

CBS Receipt: 3638895

Printed For Lead File # AMC427582

Agency Tracking ID: 1471967412

Assessment Year: 2017

Number of BLM Serial Nr: 1

Paid On: 08/23/2016

Total Amount Paid: \$155.00

Claim Name	BLM Serial No	Lead File No	Amount Paid
NELLIE MEDA	AMC427582	AMC427582	\$155.00

United States Department of the Interior
Bureau of Land Management
 BUSINESS & SUPPORT SVCS DIV
 ONE N CENTRAL AVE SUITE 800
 PHOENIX, AZ 85004 -4427
 Phone: (602) 417-9200

Receipt

No: 3638895

Transaction #: 3742810	
Date of Transaction: 08/23/2016	
CUSTOMER:	
CRYSTAL SUTTON 2091 E MURRAY HOLLADAY RD SLC,UT 84117 US	

LINE #	QTY	DESCRIPTION	REMARKS	UNIT PRICE	TOTAL
1	1.00	LOCATABLE MINERALS / MINING CLAIMS- NOT NEW-UNADJUD,ONE AUTH NO. ONLY / MINING CLAIM MONEY RECEIVED CASES: AMC427582/\$155.00		- n/a -	155.00
TOTAL:					\$155.00

PAYMENT INFORMATION			
NOTE: Items will appear on credit card statement as "BLM O Mining Claim".			
1	AMOUNT:	155.00	POSTMARKED: N/A
	TYPE:	CREDIT CARD	RECEIVED: 08/23/2016
	NAME:	CRYSTAL SUTTON 2091 E MURRAY HOLLADAY RD SLC UT 84117 US	
	CARD NO:	XXXXXXXXXXXX4131	AUTH CODE: 023127
	NAME ON CARD:	CRYSTAL SUTTON	
	EXPIRES:	11/2018	
	SIGNATURE:		

REMARKS

This receipt was generated by the automated BLM Collections and Billing System and is a paper representation of a portion of the official electronic record contained therein.

NOTICE!!

These documents have been scanned!

Do not place un-scanned documents beneath this notice!

Do not remove this notice from this file!

GPO Jacket No. 560-102
Print Order 61540
Rise Business Services, LLC
Job=AZ15 6/24/2019



Box Number= AZ15128



Claim Begin-End: AMC427582-AMC427582

5 Miscellaneous



AZ15128-10

AMC427444-AMC427733

**NO
DOCUMENTS
FOUND**

NO DOCUMENTS FOUND
NO DOCUMENTS FOUND

NOTICE!!

These documents have been scanned!

Do not place un-scanned documents beneath this notice!

Do not remove this notice from this file!

GPO Jacket No. 560-102
Print Order 61540
Rise Business Services, LLC
Job=AZ15 6/24/2019



Box Number= AZ15128



Claim Begin-End: AMC427582-AMC427582

6 Location Notices-Amendments and Supporting Documents



AZ15128-10

AMC427444-AMC427733

Mining Claim Status Report

Data Entered: 03/26/14 RAN

MTP Checked By: 03/26/14 RAN
GEO Checked By: 03/26/14 RAN

LEAD SERIAL NUMBER: AMC 427582 thru AMC _____

NUMBER OF CLAIMS & TYPE:

1 LODE
____ PLACER
____ ASSOCIATION PLACER
____ MILL SITE
____ TUNNEL SITE

CHARGES:

Location Fee @ \$34 = \$ 34
Processing Fee @ \$20 = \$ 20
Maintenance Fee @ \$140 = \$ 140
Add'l Maint Fee for Assoc Placer = \$ _____
SUBTOTAL \$ _____
Other Fees \$ _____
Other Fees \$ _____
TOTAL \$ 194

TOTAL ACREAGE: _____ Per Claim
(Placer Only)

NUMBER OF LOCATORS: _____

DOCUMENTS RECEIVED VIA : Over-the-Counter [] Mail [] **TIMELY FILED:** Yes [] No []

LEGAL DESCRIPTION: T 8W R 8W SEC 19
T _____ R _____ SEC _____
T _____ R _____ SEC _____
T _____ R _____ SEC _____
T _____ R _____ SEC _____

BLM [] FOREST SERVICE [] _____ SUBJ TO PL 359: Yes [] No []
WILDERNESS AREA [] _____

SPLIT ESTATE: N/A [] SX [] PX [] OTHER [] _____
SRHA [] Was proper Notice filed if located on SHRA Land? Yes [] No []

RECONVEYED MINERALS ON BLM LAND REQUIRE OPENING ORDER FROM 1944 TO 1993:

Open to Entry On _____ N/A []

COMMENTS/STATUS: VOID [] PARTIALLY VOID [] PVT MINERALS [] WITHDRAWN LANDS []
OTHER [] _____

AMC427582

[] Claimant acknowledges that portions of the following claim(s) site(s) may be void or voidable.

Printed Name of Claimant _____ Signature of Claimant _____

*****FINAL ADJUDICATION*****

DATE 7/1/14 INITIALS AT

LOCATION NOTICE FOR LODE MINING CLAIM

NOTICE IS HEREBY GIVEN that the NELLIE MEDA

lode mining claim has been located by

GRE INC whose current mailing

address is 2091 E Murray Holladay Road Suite 22E, SLC, UT 84117.

The general course of this claim is NORTHEAST TO SOUTHWEST

situated in YAVAPAI County, Arizona. This claim is 1500 feet in length and 600 feet in width. This claim runs from the location monument on which this location notice is posted approximately 750 feet in a NORTHEAST direction to the NORTHWEST end line and 750 feet in a SOUTHWEST direction to the SOUTHWEST end line. This claim is marked by six monuments, one at each corner and one at the center of each end line of the claim.

The location monument on which this notice is posted is situated within Section 19, Township 8N, Range 8W, Gila Salt River Base and Meridian, Arizona and this claim encompasses portions

of the following quarter section (s), section (s), Township (s) and Range (s) NE & SE ¼ OF SECTION 19 T8N R8W

Gila Salt River Base and Meridian, Arizona.

The locality of this claim with reference to some natural object or permanent monument and additional information

(if any) concerning its locality are as follows: DISCOVERY MONUMENT IS LOCATED SOUTH 82° 14 MINUTES 13 SECONDS EAST, A DISTANCE OF 14,574 FEET FROM THE PERMANENT MONUMENT LOCATED AT THE NE CORNER OF SECTION 22 T8N R9W

This Notice of Location has been written to capture mineral rights within its boundaries, only on open and locatable ground. In the case that some or parts of the claim boundaries overlap private or patented land it is understood that no rights or ownership is implied or assumed in relation to that portion of the claim. In the case that any part of this claim boundary may overlap another, pre-existing claim, it is understood that no rights or ownership is implied or assumed in relation to that portion of the claim. Any overlap or overstaking that has occurred is solely due to standard sizing of claims and there is no claim or ownership implied or assumed.

DATED AND POSTED on the ground this 29th day of December 2013

LOCATOR (s) [Signature]

BLM
Date
Stamp

RECEIVED
BLM AZ STATE OFFICE
2014 MAR 17 P 3:22
PHOENIX, ARIZONA

AMC427582

Input Parameters for Geographic Report with Land

System Id = CR

Admin State = AZ

Geo State = AZ

Casetype Begins With

Case Disp Txt = AUTHORIZED, CANCELLED, EXPIRED, PENDING, REJECTED, RELINQUISHED, WITHDRAWN

Mer Twp Rng =

Section =

Mtrs = 14 0080N 0080W 019, 14 0080N 0080W 999

Commodity =

Commodity Txt =

Pending Org =

Pend Org Decode =

Total Rows Returned: 6

RUN TIME: 09:11 AM

UNITED STATES DEPARTMENT OF INTERIOR
BUREAU OF LAND MANAGEMENT
GEOGRAPHIC REPORT WITH LAND
Sorted by Serial Number

RUN DATE: 03/26/2014
Page 1 of 1

Adm State: AZ

Serial Number: AZA 027258
Total Case Acres: 4.650

<u>Casetype</u>	<u>Case Disp</u>				<u>Sect</u>	<u>Sur Typ</u>	<u>Sur Num</u>	<u>Suff</u>	<u>Subdivision</u>	<u>Act Pend</u>
281001	AUTHORIZED	14	0080N	0080W	019	FF		1	E2E2SE;	

Serial Number: AZA 028803
Total Case Acres: 6.820

<u>Casetype</u>	<u>Case Disp</u>				<u>Sect</u>	<u>Sur Typ</u>	<u>Sur Num</u>	<u>Suff</u>	<u>Subdivision</u>	<u>Act Pend</u>
292006	EXPIRED	14	0080N	0080W	019	FF		1	PORTION OF LAND IN LOT 6; AND SWSENE SURROUNDING; PATENTED CLAIM IN LOT 5;	
						FF		2		
						FF		3		

Serial Number: AZA 031718
Total Case Acres: 0.240

<u>Casetype</u>	<u>Case Disp</u>				<u>Sect</u>	<u>Sur Typ</u>	<u>Sur Num</u>	<u>Suff</u>	<u>Subdivision</u>	<u>Act Pend</u>
286203	AUTHORIZED	14	0080N	0080W	019	ALIQ LOTS			SESE; 6;	

TOWNSHIP 8 NORTH RANGE 8 WEST OF THE GILA AND SALT RIVER MERIDIAN, ARIZONA

YAVAPAI / MARICOPA COUNTY
HASSAYAMPA FIELD OFFICE

STATUS OF PUBLIC DOMAIN
LAND AND MINERAL TITLES

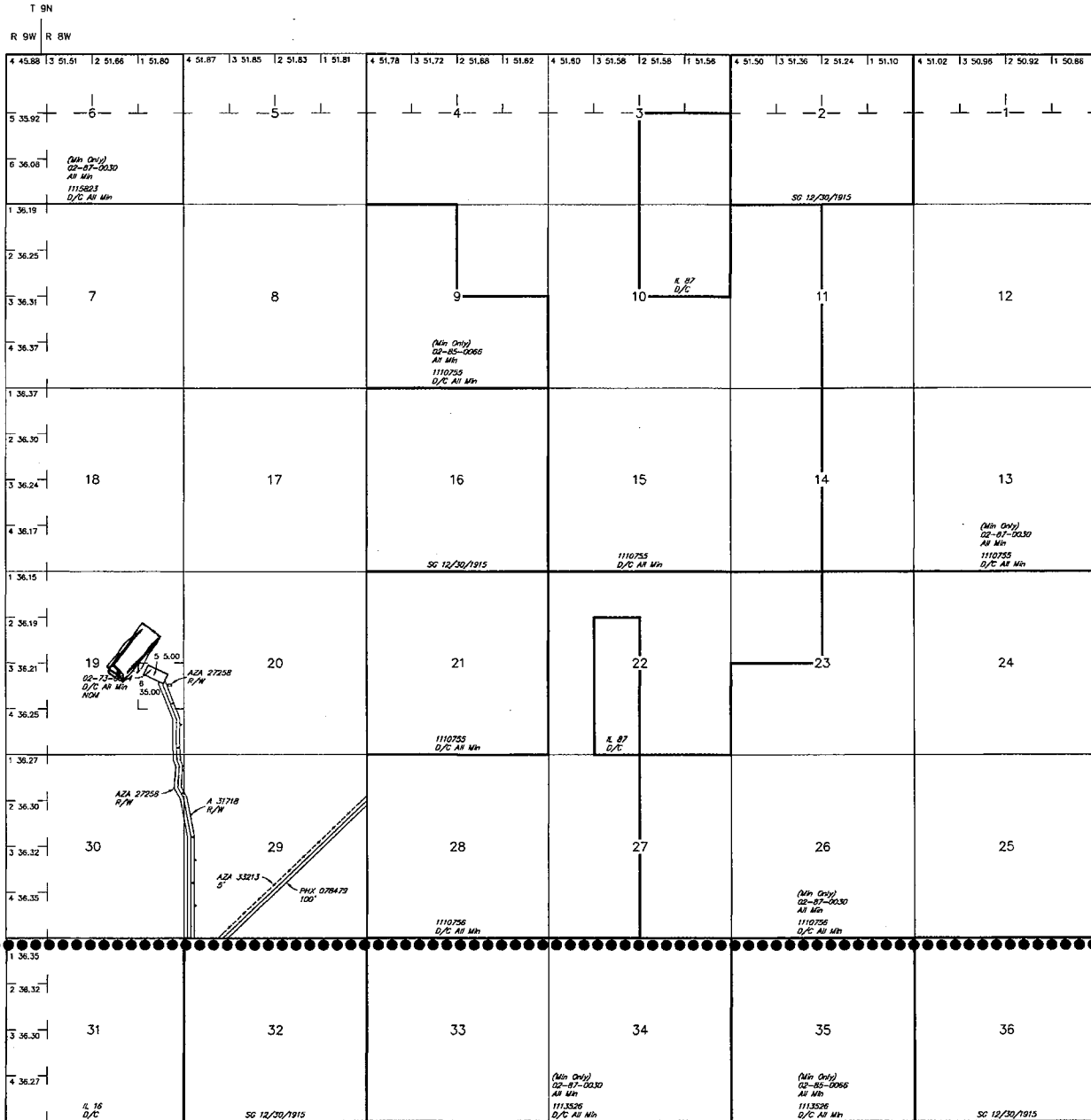

YAVAPAI
025
MARICOPA
013

INDEX TO SEGREGATED TRACTS

RESURVEY TRACT NO	ORIGINAL SURVEY		
	T	R	SECTION

FOR ORDERS AFFECTING DISPOSAL OR USE OF UNIDENTIFIED LANDS WITHDRAWN FOR CLASSIFICATION, MINERALS, WATER AND/OR OTHER PUBLIC PURPOSES, REFER TO INDEX OF MISCELLANEOUS DOCUMENTS.

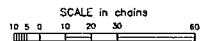

WARNING STATEMENT
This plot is the Bureau's Record of Title, and should be used only as a graphic display of the township survey data. Recorders herein do not reflect title changes which may have been effected by lateral movements of rivers or other bodies of water. Refer to the cadastral surveys for official survey information.

Lot Long 33°59'08"N 113°02'09"W

CURRENT TO	NW	GSR Mer
6-11-2012	ACAD	T 8 N
		R 8 W

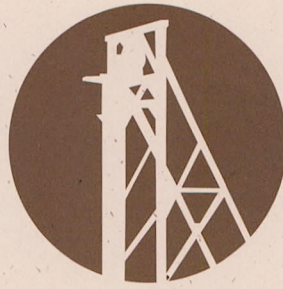

GOLD RUSH
EXPEDITIONS

3/11/2014

GRE, Inc.
2091 E. Murray Holladay Road
Suite #22E
SLC, UT 84117

Arizona BLM

Re: One Notice of Location(s)

Dear Arizona BLM Cashier,

Please find enclosed One Notice of Location (s) for filing. I understand there is a fee for recording each of these documents. I have enclosed a check for the fees. Please apply the appropriate amount owed for filing fees and send a receipt with the recorded documents.

I have also enclosed a postage paid envelope for the document(s) to be returned.

Thank you for your time and efforts.

Sincerely,

GRE Accounting
accounting@goldrushexpeditions.com
www.goldrushexpeditions.com

RUSH

RECEIVED
BLM AZ STATE OFFICE
2014 MAR 17 P 3:21
PHOENIX, ARIZONA



POSTNET barcode

GOLD RUSH
EXPEDITIONS
2091 E. MURRAY HOLLADAY RD, STE. 22E
SALT LAKE CITY, UTAH 84117

RECEIVED
BLM AZ STATE OFFICE
2014 MAR 17 P 3:21
PHOENIX, ARIZONA

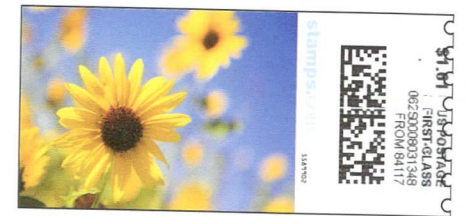

Arizona BLM
Attn: Cashier
One N. Central Ave., Ste. 800
Phoenix, AZ 85004

